



奧迪美®

SC212

SKIMCOAT (FLEXIBLE TILE FILLER)

SMOOTHING MORTAR FOR EXISTING CONSTRUCTION SURFACES

PRODUCT DESCRIPTION

OPTIMIX SC212 SKIMCOAT (FLEXIBLE TILE FILLER) is a premium quality water resistant polymer modified cementitious surface smoothing mortar. It is specially designed to achieve good adhesion to a wide variety of common substrates to produce a smooth durable surface ideal for painting or other traditional finishes. Suitable substrates include existing tiled, stone faced and grouted surfaces as well as concrete, mortar, brick work, block work and similar.

Available in white and grey colour it is suitable for application by machine spraying, hopper gun or hand trowelling.

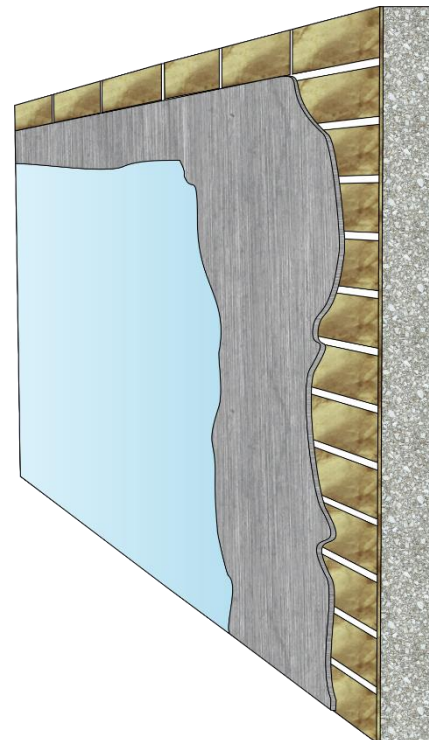

TYPICAL USAGE

- Touch up uneven surface and substrate defects for new or refurbishment projects
- Renovation work for building façade
- Suitable for both smooth and textured surface
- Re-surfacing of mosaic tile, ceramic tile and granite stone
- For interior and exterior applications onto walls and ceilings

FEATURES AND BENEFITS

- Easy to Use – Trowellable and Sprayable
- Cost Effective – Can Avoid Unnecessary Hacking-off of Stable Substrates
- Excellent Masking Ability
- Good Bonding Performance
- Water and Mould Resistant
- Consistent Quality
- Extremely Low VOC and Heavy Metals
- Excellent Polished Finish

TECHNICAL DATA

| Product Characteristics | OPTIMIX SC212 |
|---|---------------|
| Compressive Strength at 28 days | 15 MPa |
| Flexural Strength at 28 days | 4 MPa |
| Tensile Adhesive Strength at 28 days | 1.5 MPa |
| Drying Shrinkage at 28 days | NIL cracks |
| Thickness per Coat | 1 – 3 mm |
| Number of Coats & Total Thickness (suggested) | 2 coats / 5mm |

Note: The above are typical laboratory test results and can vary slightly depending on the ambient and substrate conditions during application.

| Environmental Data | |
|----------------------------------|---|
| Volatile Organic Compounds (VOC) | ≤ 10 g/L |
| Potential BEAM points | Product is manufactured within 800km of Hong Kong project sites |
| Packaging Composition | Paper bags incorporating 40% recycled paper |



| Packaging & Yield | |
|---------------------|--------------------------|
| Wet Density | 1,700 kg/m ³ |
| Water Demand | 12.5 – 14.5 L |
| Coverage | 1.3 kg/mm/m ² |
| Packaging (per bag) | 40 kg |
| Shelf Life | 12 months |

Note: The above are approximate figures and take no account of wastage of any kind.

| TESTING METHODS | |
|------------------------------------|---------------------------------|
| Compressive and Flexural Strengths | BS EN 1015 – 11 |
| Tensile Adhesive Strength | BS EN 1015 – 12 |
| Drying Shrinkage (Coutinho Ring) | HKHA MTS Spec. Part D Cl. 2.1.6 |
| VOC Content | USEPA Method 24 |

Note: The tests were performed according to the national standard or in-house modifications of the corresponding testing procedures.



INSTALLATION GUIDE

(Refer to Method Statement for more details)

SURFACE PREPARATION

The surface should be carefully inspected to ensure that it is strong and sound enough to receive additional construction layers.

Surface should be cool, clean and free from loose or unsound materials, oil, grease and other contaminants. It is recommended to clean the substrate with water jet and /or scrubbing to remove accumulated grime, dust and loose particles.

Immediately before application, the substrate surface should be inspected to confirm its cleanliness and dampened with clean water so as to ensure the adhesion properties.

MIXING

Mix one bag of **OPTIMIX SC212** dry powder with 12.5 – 14.5 L potable water. Mechanical mixing using a proprietary mixer or power drill fitted with a suitable paddle is recommended. Mix the material for about 5 minutes or until a lump-free homogeneous mix is achieved. Allow the mixture to stand for 5 minutes, mix briefly again and the material is ready for use.

APPLICATION

Apply the **OPTIMIX SC212** onto the substrate within the working life of the mixed mortar. This will be somewhat dependent upon ambient temperature and relative humidity on site. Float the mortar to achieve an even spread over the surface and work the mortar to ensure that it has full contact with the substrate and fills any voids or surface texture such as grouted joints between tiles. Excessive mortar can be leveled off using a straight edge or trowel.

When air bubbles appear on the skimcoat surface, this typically indicates there are imperfections or pin-holes at the underlying substrate. Such air bubbles are the enclosed

air within the substrate pin-holes which expand and rise onto the skimcoat surface.

It is suggested to wait for 1-2 hours – depending on site conditions – before finishing allowing all the bubbles to be formed and released so that they can be removed during finishing.

FINISHING

Any air bubbles or blemishes at the skimcoat surface can be removed with a careful trowel pass after the surface has firmed up a little. Use very light pressure and take care not to drag the mortar away from or across the substrate as this will damage the bond. Do not add water to the mortar surface, however if necessary the trowel can be dampened with a damp cloth to assist in achieving a smooth surface.

If appropriate, a local touch up with skimcoat on the minor surface pin-hole areas can be performed to provide a smooth finishing surface.

If additional layers are applied allow the previous layer to harden for at least one day before applying the second layer in the same way as the first.

The finished surface should be flat and smooth. Its levelness is largely dictated by the contour of the substrate and the application skills.

The surface can be polished with suitably fine sand paper to remove the trowel marks. It is recommended to allow 3 to 7 days before coating is applied over the hardened mortar surface.

HEALTH AND SAFETY

OPTIMIX SC212 is alkaline in nature and can cause irritations to persons with sensitive skin. Avoid inhalation of dust and contact with skin and eyes. Wear suitable protective gloves and masks while handling the product. If contact with eyes, rinse immediately with plenty of clean water and seek medical advice. This product is non-toxic and is not flammable.

STORAGE

Store the products in a cool and dry place with the original unopened bags on pallets with plastic wrapping. Protect from direct sunlight, rainfall and exposure to high humidity conditions. Avoid excessive stacking of pallets. Failure to comply with the recommended storage conditions may result in premature deterioration of the product or packaging and reduce shelf life.

ALTERNATIVE PRODUCTS

Other products from the Optimix range which can be used for pre-painting, smoothing and levelling include:

- **SC216** Skimcoat (Fine)
- **SC228** Skimcoat
- **SC273** Skimcoat (Putty for Paint)



Important Note: The information contained herein is, the best of our knowledge, true and reliable and is supported by the present state of our knowledge. No warranty is given or implied in connection with any recommendations or suggestions made by us or our representatives as the conditions of use and any labour involved are beyond our control.



OPTIMIX (HONG KONG) LIMITED

20/F, SUP Tower, 75-83 King's Road, North Point, Hong Kong

☎ [852]2395 5388

☎ [852]2802 6408

🛒 [852]2802 6433

🌐 www.optimix.com.hk

